

\$1,000,000 - 701 14105 West Block Drive, Edmonton

MLS® #E4461289

\$1,000,000

2 Bedroom, 2.50 Bathroom, 1,648 sqft

Condo / Townhouse on 0.00 Acres

Glenora, Edmonton, AB

Experience elevated living in this stunning 1650 sq ft, 2 bedroom + den, 2 bathroom condo in the prestigious West Block tower. This spacious corner unit features soaring 9 ft ceilings, floor-to-ceiling windows with breathtaking river valley views, and a bright open living room with a cozy fireplace. The chef-inspired kitchen boasts sleek cabinetry, premium built-in appliances, a large island, and quartz countertops, while the primary suite offers a spa-like ensuite with double vanity, glass shower, and soaker tub. Both bedrooms are generously sized, and the private balcony showcases sweeping city and river views. Enjoy luxury amenities including concierge service, fitness centre, dog and car wash, guest suite, party and recreation rooms, and secure underground parking. With coffee shops, dining, shopping, schools, transit, and the river valley all just steps away, this residence delivers the ultimate urban lifestyle.

Built in 2019

Essential Information

MLS® #	E4461289
Price	\$1,000,000
Bedrooms	2
Bathrooms	2.50
Full Baths	2

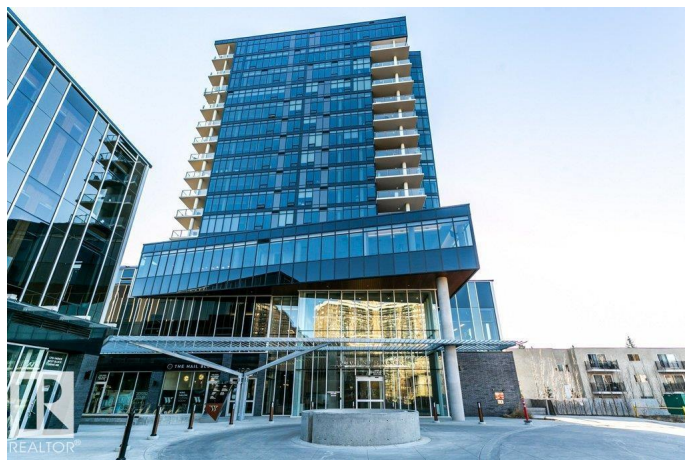

Half Baths	1
Square Footage	1,648
Acres	0.00
Year Built	2019
Type	Condo / Townhouse
Sub-Type	Apartment High Rise
Style	Single Level Apartment
Status	Active

Community Information

Address	701 14105 West Block Drive
Area	Edmonton
Subdivision	Glenora
City	Edmonton
County	ALBERTA
Province	AB
Postal Code	T5N 1L5

Amenities

Amenities	Air Conditioner, Car Wash, Ceiling 9 ft., Closet Organizers, Deck, Dog Run-Fenced In, Exercise Room, Guest Suite, No Animal Home, No Smoking Home, Parking-Visitor, Party Room, Patio, Security Door, Concierge Service
Parking	Parkade, Underground

Interior

Interior Features	ensuite bathroom
Appliances	Dishwasher-Built-In, Dryer, Oven-Built-In, Refrigerator, Stove-Gas, Washer, Window Coverings
Heating	Heat Pump, Natural Gas
Fireplace	Yes
Fireplaces	Tile Surround
# of Stories	16
Stories	1
Has Basement	Yes
Basement	None, No Basement

Exterior

Exterior	Concrete, Brick
----------	-----------------

Exterior Features	Corner Lot, Playground Nearby, Private Setting, Public Transportation, River Valley View, River View, Schools, Shopping Nearby, View City, View Downtown
Roof	EPDM Membrane
Construction	Concrete, Brick
Foundation	Concrete Perimeter

School Information

Elementary	Grovenor School
Middle	Westminster School
High	Ross Sheppard School

Additional Information

Date Listed	October 8th, 2025
Days on Market	1
Zoning	Zone 11
Condo Fee	\$1,690

DATA IS DEEMED RELIABLE BUT IS NOT GUARANTEED ACCURATE BY THE REALTORS® ASSOCIATION OF EDMONTON. COPYRIGHT 2025 BY THE REALTORS® ASSOCIATION OF EDMONTON. ALL RIGHTS RESERVED.Trademarks are owned or controlled by the Canadian Real Estate Association (CREA) and identify real estate professionals who are members of CREA (REALTOR®, REALTORS®) and/or the quality of services they provide (MLS®, Multiple Listing Service®)

Listing information last updated on October 9th, 2025 at 1:02am MDT